

ARCANE WARRIOR®

STORM Side-Mounted Storage Box –
Pro Version

Compatible Model: LC250 – OPT

Installation Time: Approximately 10 minutes

Thank you for purchasing the ARCANE WARRIOR STORM Side-Mounted Storage Box.

For safety and reliability, please read this installation manual carefully before installation, and follow the steps strictly.

Load Capacity

Maximum Load: 17 kg

Parts List

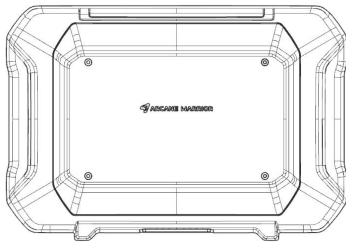

Storage Box
Main Body*1

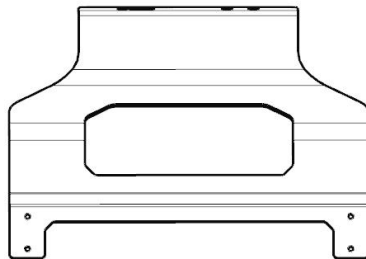

Upper Link
Bracket*1



Lower Link
Bracket*1

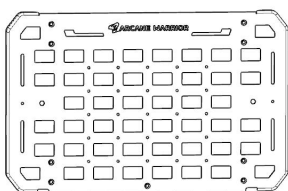

Shelf Board*1

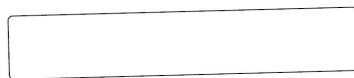

Rhino Skin *1

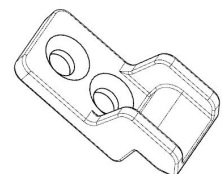

Positioning
Hook *4

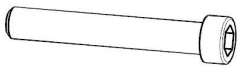

M6x20 Screws*2

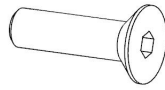

M5x16 Countersunk
Screw*8

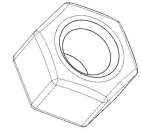

M5 Lock Nut*8

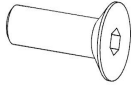

M5x12 Countersunk
Screw*8

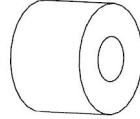

M6x18-10 Waterproof
Spacer*2

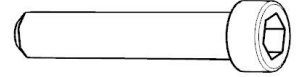

M8x45 Screw*4

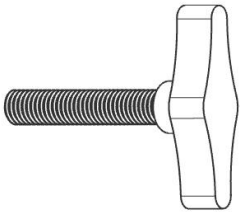

M6 Wing Bolt*2

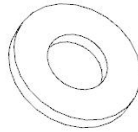

M6 Flat Washer*4

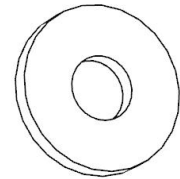

M8 Flat
Washer*4



Lower Mounting
Bracket *1

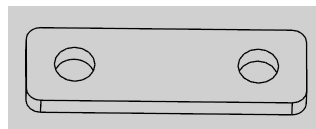

Double-Hole
Washer*2

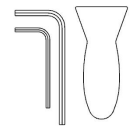

Tools*1

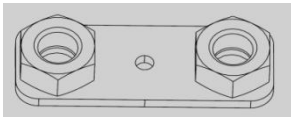

Double-Hole Nut
Washer*2

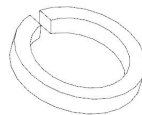

M8 Spring
Washer*4

Installation Steps: (This installation is shown for the driver side. To install on the passenger side, assemble in the same manner.)

1

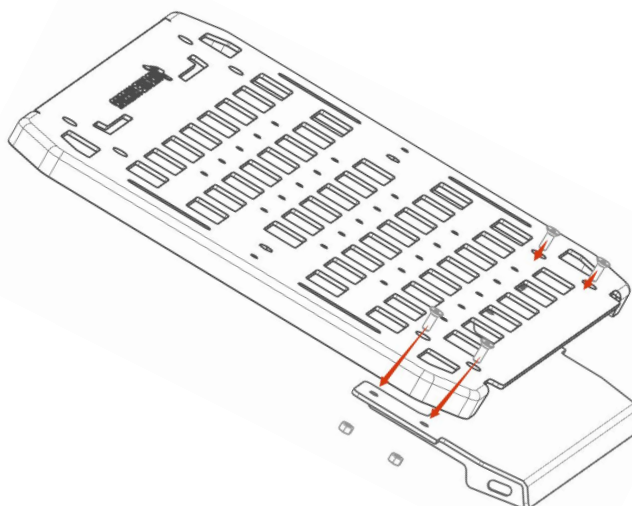

Use four M5×16 countersunk screws to secure the lower link bracket to the quick-release plate, and tighten four M5 lock nuts on the back.

2

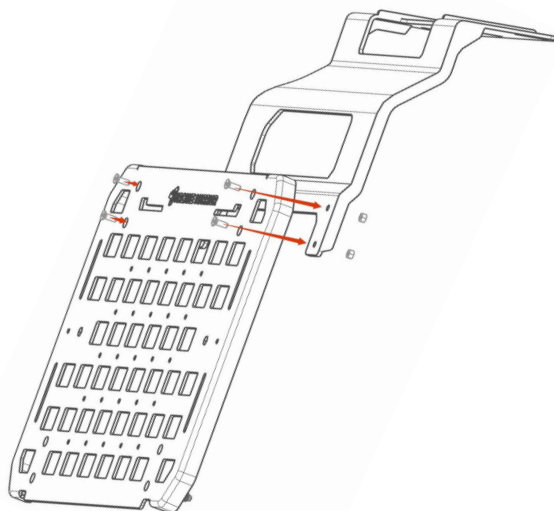

Use four M5×16 countersunk screws to secure the upper link bracket to the quick-release plate, and tighten four M5 lock nuts on the back.

3

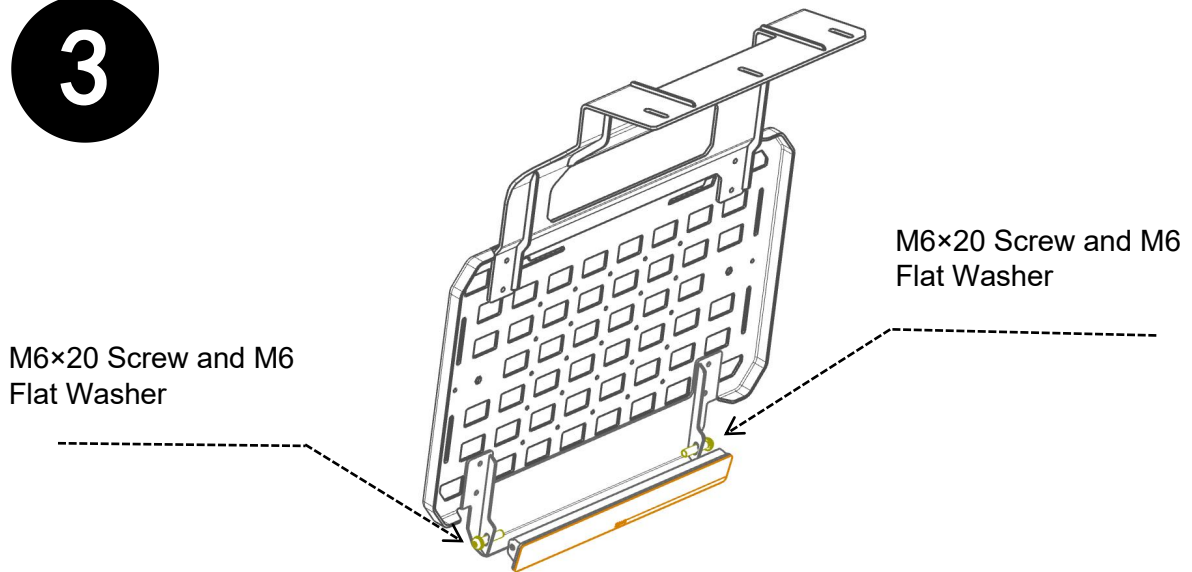

Pre-assemble the lower link bracket with the lower mounting bracket, using M6×20 screws and M6 flat washers to secure (**do not fully tighten the screws**).

4

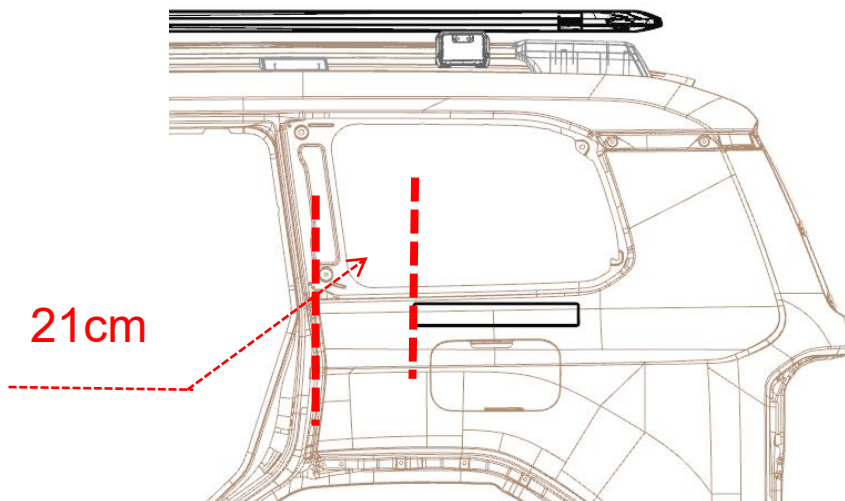

Wipe the illustrated area with a damp cloth and apply the Rhino Skin. Use a scraper to remove any trapped air, and wipe the surface of the Rhino Skin with primer. (**Pay attention to the correct placement of the Rhino Skin.**)

M8 Screw

5

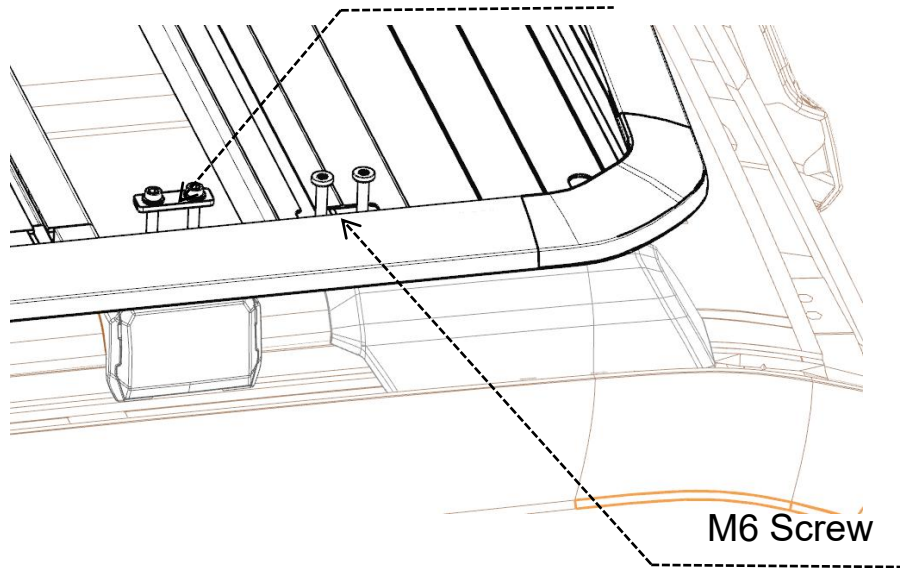

M6 Screw

Remove the rear mounting screw of the driver-side platform (there is a nut under the M6 screw; you can push the nut into the empty space using a thin cable tie or wire, and secure it with the removed M6 screw to prevent movement).

6

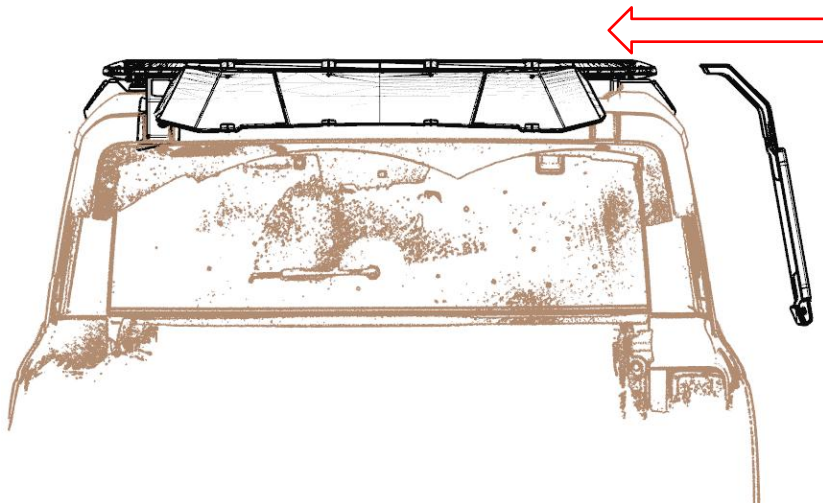

Insert the assembled storage rack into the platform and vehicle body along the direction indicated by the arrow.

7

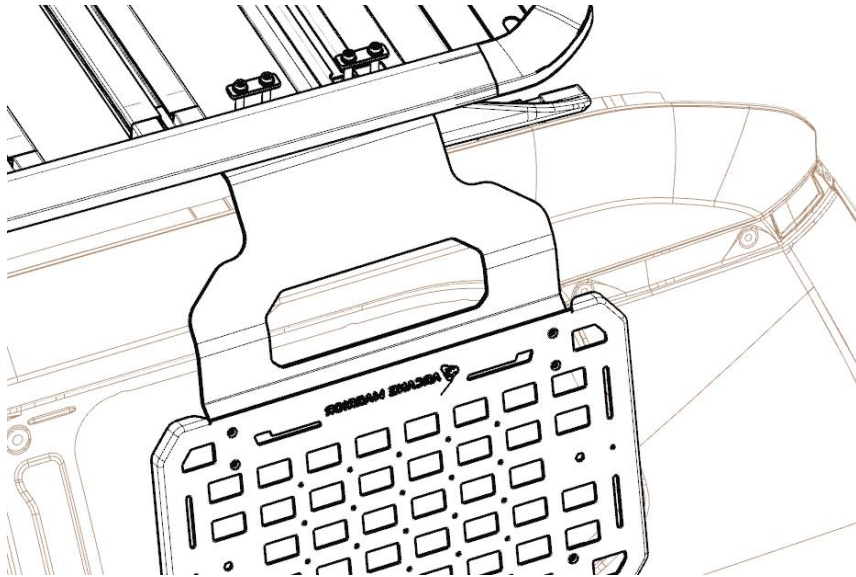

Use four M8×45 screws, passing through spring washers and flat washers, then through the platform, upper bracket, and platform bracket. Secure from below with double-hole nuts (do not fully tighten the screws).

8

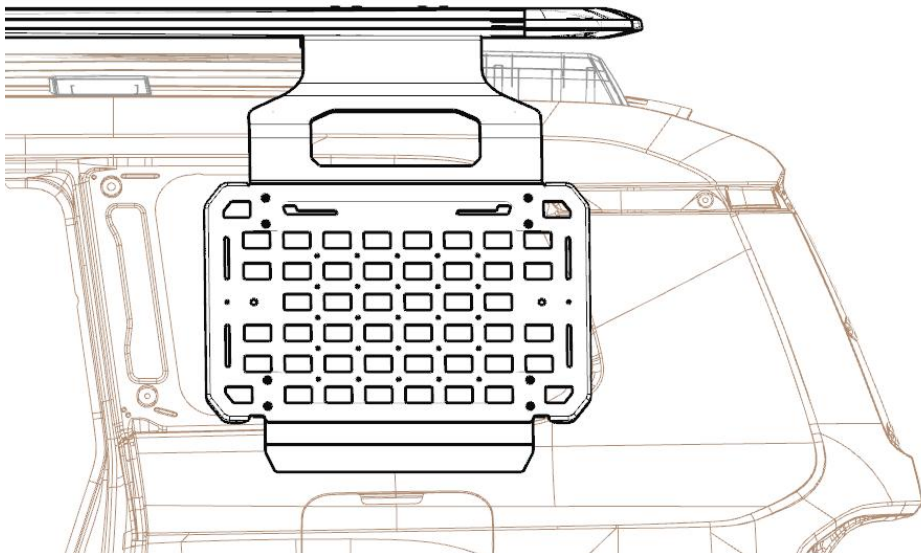

Adjust the position of the storage rack until it fits the vehicle body. Peel off the release paper from the 3M adhesive on the bottom and press the bottom onto the Rhino Skin.

9

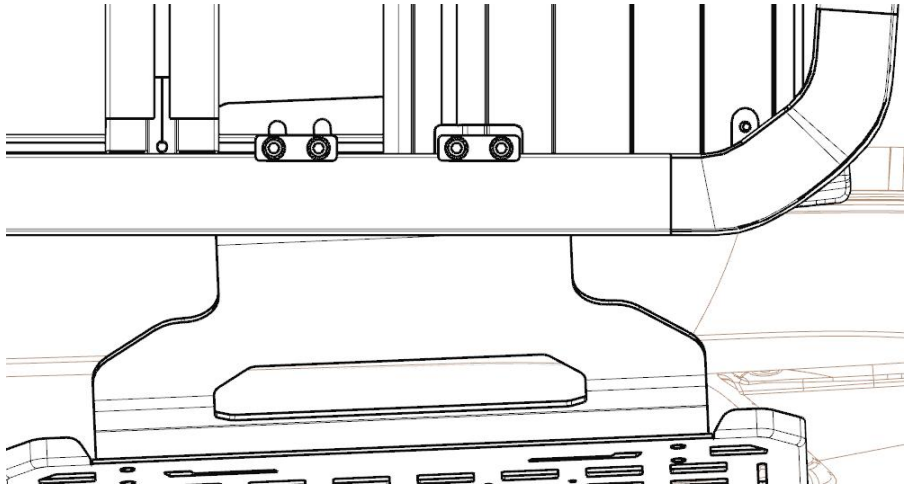

Tighten the top screws.

10

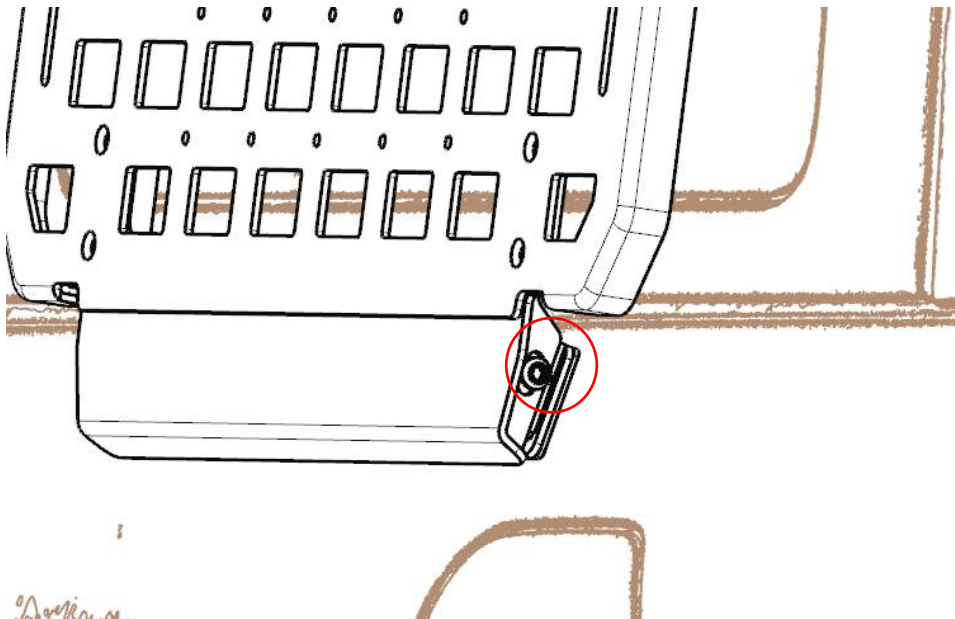

Tighten the screws on both sides to secure the lower link bracket to the lower mounting bracket. Installation is complete.

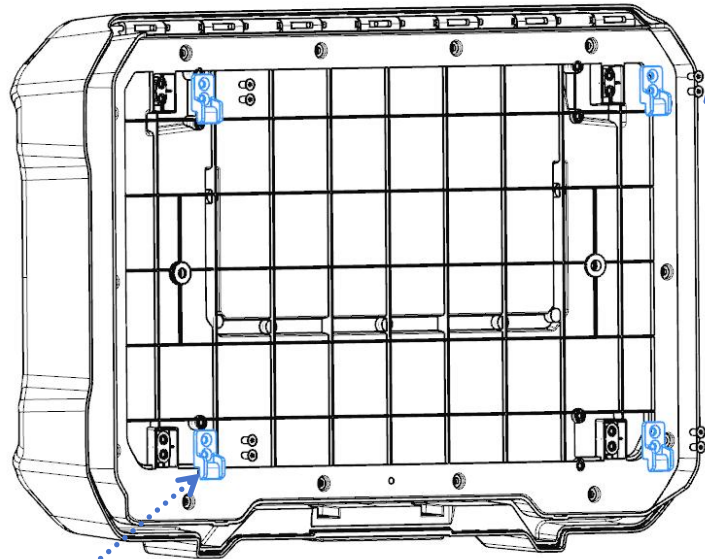
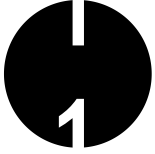

M5×12 Screw

Positioning
Hook

Use eight M5×12 screws to secure the four positioning hooks to the back of the storage box.

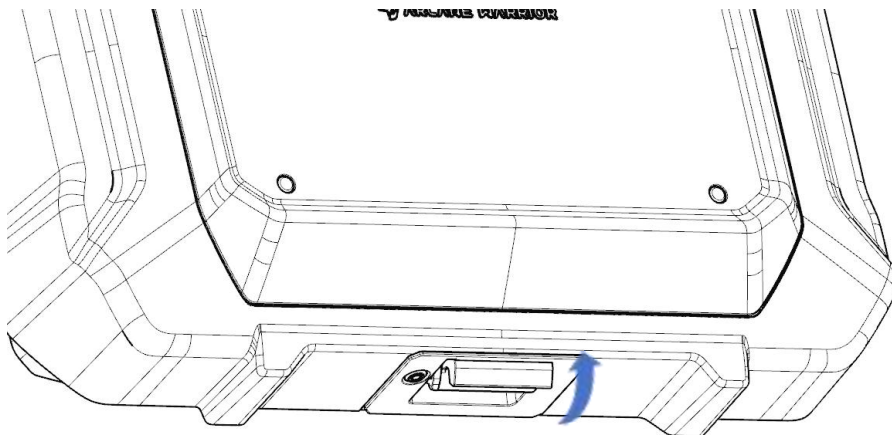

Pull the latch outward to open the outer lid of the storage box.

Note: When the outer lid opens to 30°, it will be automatically supported by the spring; be careful to avoid pinching your hands

1
3

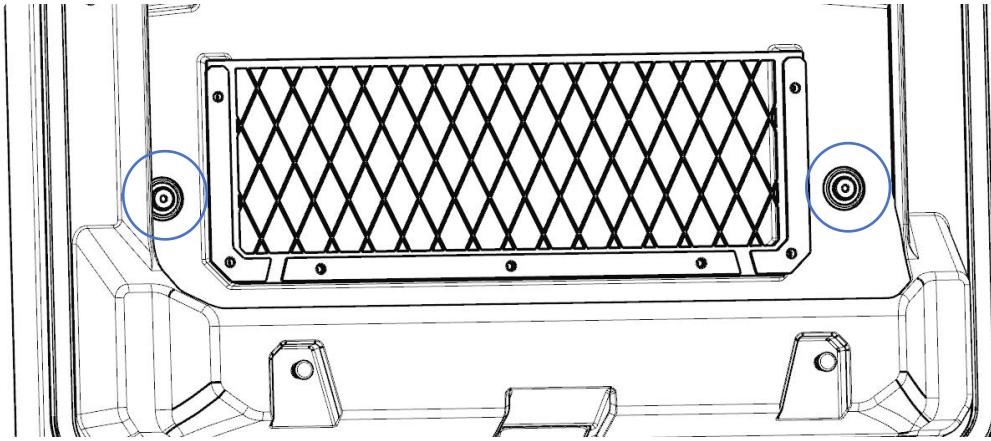

Use two 4 mm wrenches to remove the interlocking screws and waterproof washers on both sides of the mesh bag. Be sure to keep the removed parts.

1
4

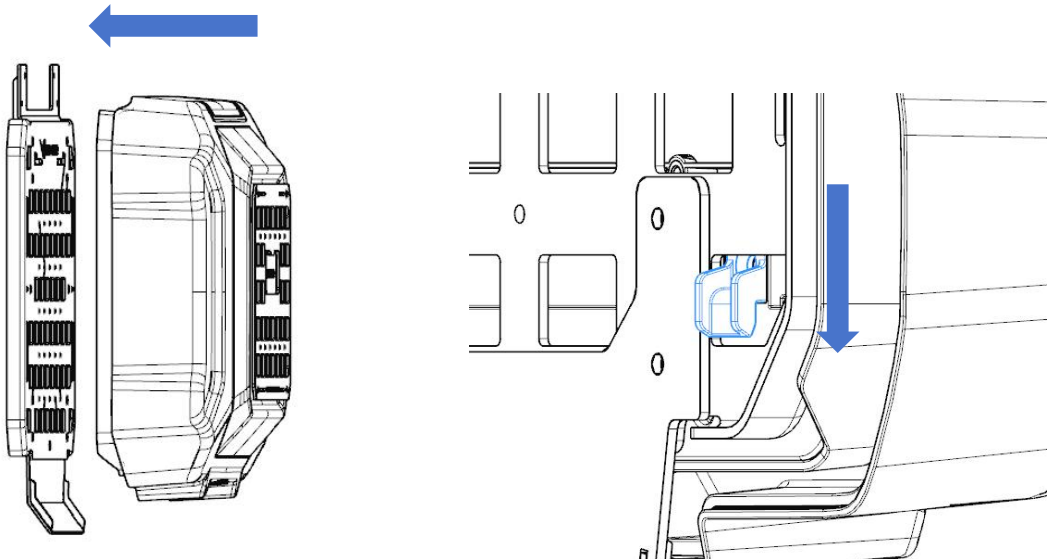

Place the storage box onto the quick-release plate, adjust its left and right position, and engage the positioning hooks into the slots of the quick-release plate.

Note: After engaging, gently pull the four corners to ensure they are properly secured.

1
5

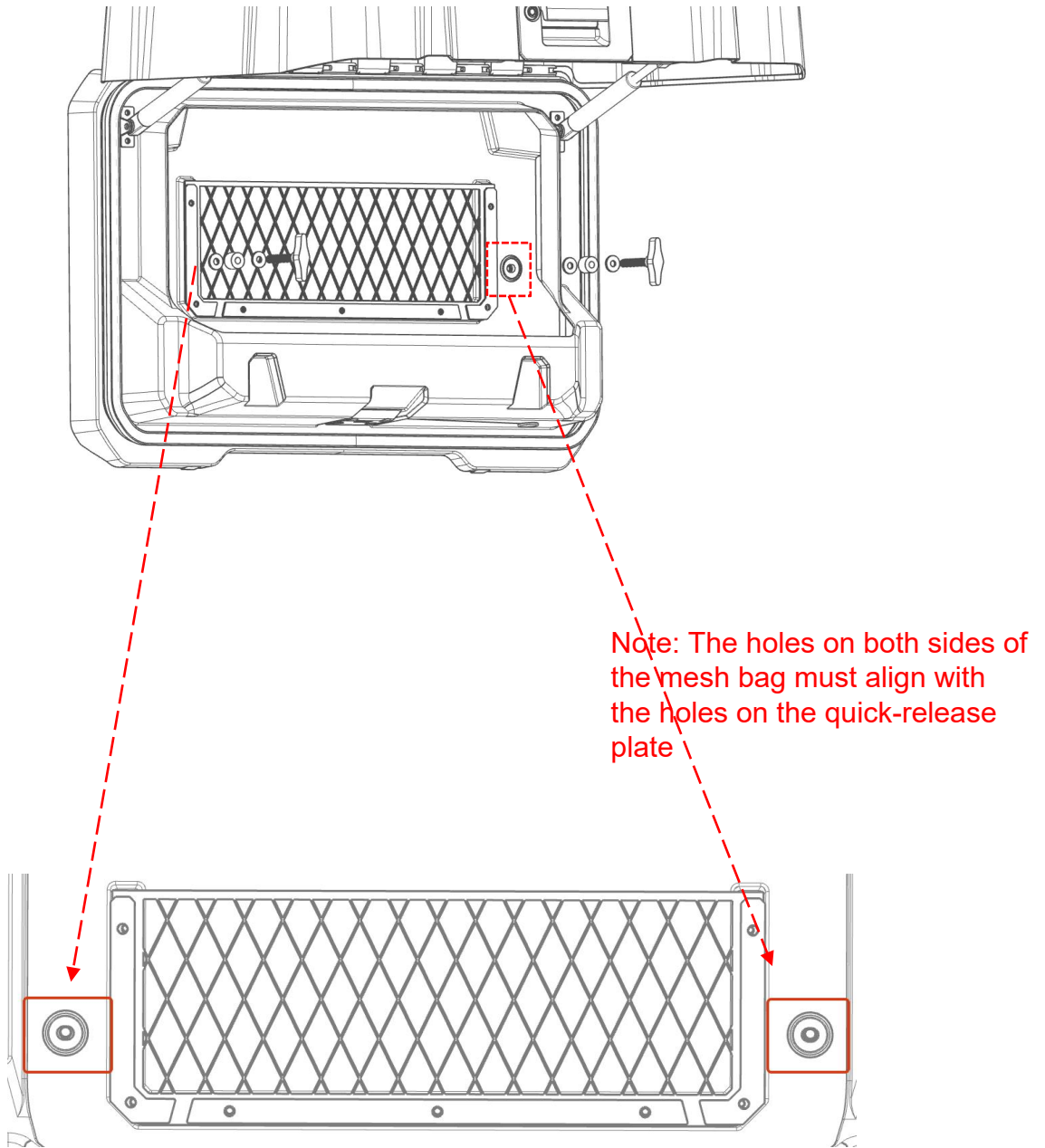

Open the top lid of the storage box. Use two M6 wing screws, passing them through two M6 flat washers and two M6×18-10 waterproof spacers, to secure the storage box to the quick-release plate.

1
6

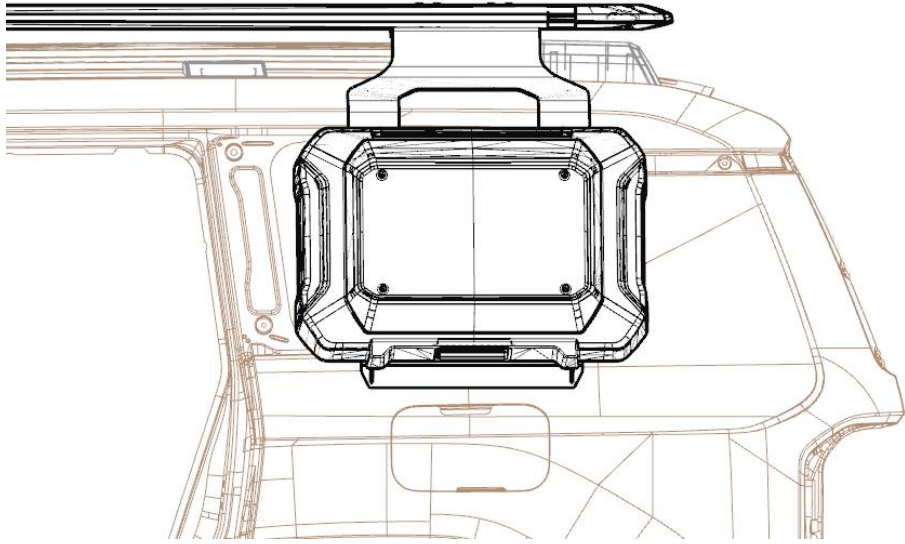

Installation Complete